

Description

- Operation mode and max sensing range:
Thru-beam: Dependent on amplifier (up to 30m)
- M30 nickel-plated brass housing
- Integrated preamplifier
- High tolerance to hostile environments
- Cable connection
- Wide range of photoelectric amplifiers
- Approval certificate ESP 14 ATEX 1 696X
- EX classification protection class:
 II 2G Ex db IIC T6 Gb
 II 2D Ex tb IIIC T80°C Db
 *Suitable for zone 1 and zone 21



The remote sensor G 30 EX series, consists of a transmitter LT and receiver LR, is made to operate in conjunction with a Telco photoelectric amplifier from the PA, MPA or PAB programmes.

This series is housed in a robust M30, nickel-plated brass housing, with cable connection, which is intended to be used in thru beam operation mode. The Telco remote sensors G 30 EX series is intended to be

installed on equipment where there is a risk of gas, steam or vapor in combination with air which creates an atmosphere of explosive mixture. The sensors operates in conjunction with a photo amplifier, which is to be mounted outside the EX area.

The receiver consists of a silicon phototransistor with an integrated preamplifier in hybrid technology.

Technical Data

		LT	LR
Transmitter diode		Ga Al (940 nm)	-
Photo transistor		-	Silicon NPN
Opening angle		+/- 15°	
Housing material	Sensor housing	Nickel Plated Brass	
	Front lens	Glass	
Estimated life time		100.000 hours approx. (12 years approx.)	
Cable, Ø 6 mm Oilflex		2 x 1,5 mm²	
Min. cable bending radius		60 mm	

Environmental Data

Vibration	10-55 Hz, 1,5 mm
Shock	30 g
Light immunity, @ 20° incidence	40 000 lux
Temperature, operation	-25 to +55 °C
Temperature, storage	-40 to +80 °C
Sealing class	IP 67
Approvals certificate	ESP 14 ATEX 1 696X
EX class	Protection class: II 2G Ex db IIC T6 Gb II 2D Ex tb IIIC T80 °C Db

Available Types

	Series	Optical Angle	Connection		15 m cable
			Housing Material	Housing Type	Order Reference
Transmitter	G 30 EX	+/- 15°	Nickel Plated Brass	M30 x 1	LT G 30 EX 15
Receiver					LR G 30 EX 15

Note: 1. Photo amplifiers to be ordered separately.

Applicable Photoelectric Amplifiers and Maximum Ranges

Amplifier Series	PA 11	PA 15	MPA 21	MPA 41		MPA 81		PAB 10	PAB 20	PAB 30
				A/B	C/D	A/B	C/D			
Remote Sensor										
G 30 EX	30 m	30 m	18 m	13 m	7 m	13 m	7 m	30 m	20 m	20 m

Connections

	Cable
Transmitter Signal	Brown
Transmitter Ground	Blue
Receiver Signal	Brown
Receiver Ground	Blue

Wiring Diagrams

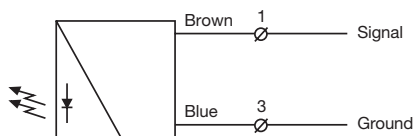

LT G 30 EX

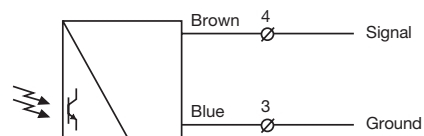

LR G 30 EX

Dimensions

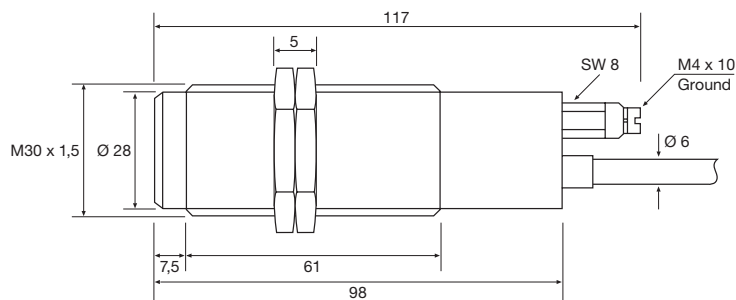

G 30 EX

(Units in mm)